



## 360x500 SHI-LR 34x1,1

360	360	300	360	300	x	x
500x350	420x300	300x200	420x260	250x280	500x220	410x195
3x400V 50 Hz	3,0	20-100	4780x34x1,1	740		
L 2800	B 1080	Hmin 1470	Hmax 2340	V 812		



STANDARD OPTION

360-F

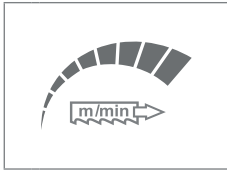

360-PCK

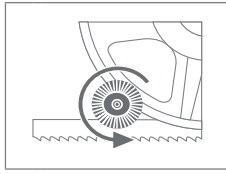

PEGAS-BRP

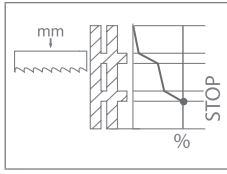

360-PUD

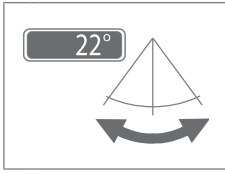

360-IPB

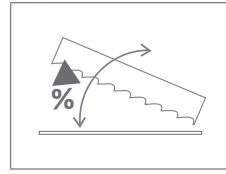

LIGHT L1

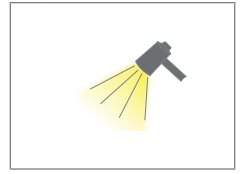

WGUN1

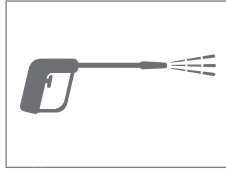

LASER LINE

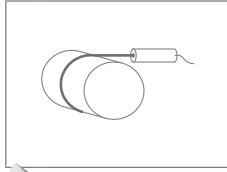

360-HP

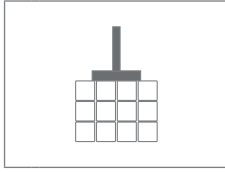

MINI LUBE 27-34



360-RTS

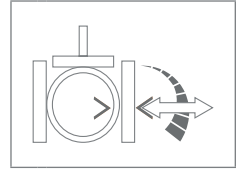

360 TAL

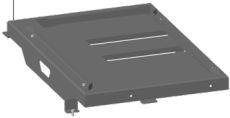

360-RBR

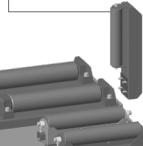

BOX-TRI

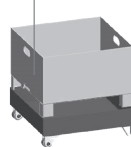

BOX-PCS

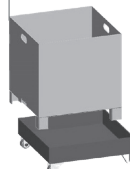

BOX-TAH



360 RDL

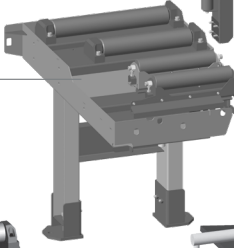

RBRs 280 +RB



RBR 280/520

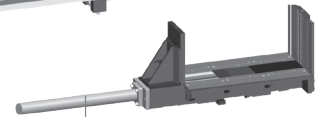

RDH-600



360-RBR



360-SRZ

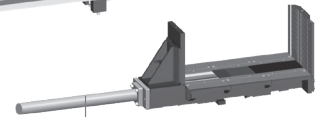

360-TAR

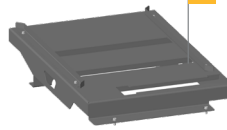

VD-VB-190



RDM 2000/520



VD-V-520



VZM-520 +RDT



V-520

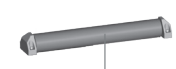

VD-2000/520/60/6  
VD-2000/520/60/10



RDML 2000/520



RDT 2000/520

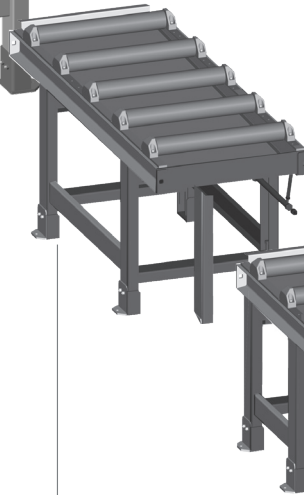

RDT 1000/520

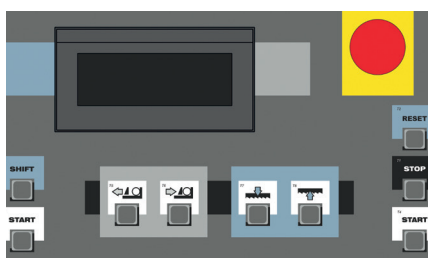

CONTROL PANEL: MITSUBISHI

## 360x500 SHI-LR

- výrobce si vyhrazuje právo provádět změny technických údajů, technické údaje odpovídají 1.1.2024 / producer has the right to make changes of technical data, technical data are valid on 1.1.2024

- pila na fotografii není vždy v základním provedení, uvedené rozměry odpovídají stroji v základním provedení / the machine in the picture is not always in the basic version, mentioned diameters are for machine in basic version

\* doporučená hodnota. Při překročení doporučeného maximálního průměru není možné garantovat výkon pilového pásu!

/ recommended value. The blade performance cannot be guaranteed when the recommended diameter is exceeded!

☒ - řezání svazků bez horního přitlačení / cutting of the bundle without top clamping



PEGAS - GONDA s.r.o.  
Čs.armády 322, 684 01 Slavkov u Brna,  
CZECH REPUBLIC

www.pegas-gonda.cz  
00420-544 221 125 (126) | pegas@gonda.cz